



## **7 TON HYDRAULIC LOG SPLITTER**

**HLS 70P**

### **ASSEMBLY, TESTING, OPERATION, SERVICING & STORAGE INSTRUCTION**

---

## **ELECTRIC**

---

### **WARNING!**

**READ and UNDERSTAND this manual completely before using The log splitter. All operators of this equipment must read and completely understand all safety information, operating instructions, maintenance and storage instructions.**

**Please check all bolts, screws, handles, clamps & clips are tight before each use.**

**Failure to properly operate and maintain the log splitter could result in serious injury to the operator and bystanders from moving parts that can crush or cut, flying objects, burns, fire or explosion, escaping high pressure hydraulic fluid, or carbon monoxide poisoning.**

---

# TABLE OF CONTENTS

	Page
<b>1.0. Disclaimer</b>	<b>3</b>
1.1. About your Log Splitter .....	3
<b>2.0. Safety Usage</b>	<b>4</b>
2.1. General Safety .....	4-5
<b>3.0. Assembly Instructions</b>	<b>6</b>
<b>4.0. Pre-checks Before Operations</b>	<b>9</b>
4.1. Electrical requirements .....	9
4.2. Select location .....	9
<b>5.0. Operations Instruction</b>	<b>10</b>
<b>6.0. Storage, Usage &amp; Maintenance</b>	<b>11</b>
6.1. Loading Log .....	11
6.2. Operator Position .....	11
6.3. Second Person .....	11
6.4. Log splitter operation .....	11
6.5. Freeing a jammed log .....	12
6.6. Replacing hydraulic oil .....	12
6.7. Sharpening the Wedge .....	12
<b>7.0. Specifications</b>	<b>13</b>
<b>8.0. Troubleshooting Guide</b>	<b>14-15</b>
<b>9.0. Warranty</b>	<b>16</b>

---

# 1.0 DISCLAIMER

## 1.1. About your Log Splitter

Congratulation on purchasing your new 7ton Yukon log splitter

This log splitter is designed to split wood logs using a hydraulically powered moving wedge. The log splitter's 240v powered engine is used to pressurize the hydraulic system.

The technical specifications for your log splitter are provided in the Specifications section (Page 12) of this manual.

### ATTENTION:

***All Rental Companies and Private Owners who loan this equipment to others!***

All persons to whom you rent, loan or use this the log splitter must have access to and read this manual.

Keep this owner's manual with the splitter at all times and advise all persons who will operate the machine to read it.

You must provide instruction on how to safely operate the splitter and remain available to answer any questions a renter/borrower might have.

The log splitter is heavy power machine and can crush, burn and cause serious ***injury*** if proper safety precaution and not taken.

Follow all safety precautions presented throughout this manual, for safely moving, towing and operating this 60 ton log splitter.

***Read the Owner's Manual completely*** before operating the machine to understand how to safely operate and maintain the log splitter.

---

**ALWAYS MAKE SURE SAFETY LABELS ARE IN GOOD CONDITION.**

**Failure to follow all instructions and warnings exactly may result in serious injury and/or damage to the product which will void all implied and express warranties**

---

---

## 2.0 SAFETY USAGE

### 2.1. General Safety

- **UNDERSTAND YOUR LOG SPLITTER**

Read and understand the owner's manual and labels affixed to the log splitter. Learn its application and limitations as well as the specific potential hazards peculiar to it.

- **DRUGS, ALCOHOL AND MEDICATION**

**Do not** operate the log splitter while under the influence of drugs, alcohol, or any medication that could affect your ability to use it properly.

- **AVOID DANGEROUS CONDITIONS**

Put the log splitter on a 60 – 75cm high, stable, flat, and level work bench where there is plenty of room for handling, and help the operator stay alert.

Bolt the log splitter to the work surface if it tends to slip, walk, or slide. Keep your work area clean and well lighted. Cluttered areas invite injuries.

**Do not** use the log splitter in wet or damp areas or expose it to rain.

**Do not** use it in areas where fumes from paint, solvents or flammable liquids pose a potential hazard.

- **INSPECT YOUR LOG SPLITTER**

Check your log splitter before turning it on. Keep guards in place and in working order.

Form a habit of checking to see that keys and adjusting wrenches are removed from tool area before turning it on. Replace damaged, missing or failed parts before using it.

- **DRESS PROPERLY**

Do not wear loose clothing, gloves, neckties or jewelry (rings, wrist watches). They can be caught in moving parts. Protective electrically nonconductive gloves and non-skid footwear are recommended when working. Wear protective hair covering to contain long hair, preventing it from get caught in machinery.

- **PROTECT YOUR EYES AND FACE**

Any log splitter may throw foreign objects into the eyes. This can cause permanent eye damage. Always wear safety goggles. Everyday eyeglasses have only impact resistant lenses. They are not safety glasses.

**Do not** put the log splitter on the ground for operations. This is awkward operating position that the operator has to bring his face close to the machine, and thus risks being struck by wood chips or debris.

- **EXTENSION CORDS**

Improper use of extension cords may cause inefficient operation of the log splitter which can result in overheating.

Be sure the extension cord is no longer than 10m and its section is no less than 2.5mm<sup>2</sup> to allow sufficient current flow to the motor.

Avoid use of free and inadequately insulated connections. Connections must be made with protected material suitable for outdoor use.

- **AVOID ELECTRICAL SHOCK**

Check that the electric circuit is adequately protected and that it corresponds with the power, voltage and frequency of the motor.

Check that there is a ground connection, and a regulation differential switch upstream. Ground the log splitter. Prevent body contact with grounded surfaces: pipes, radiators, ranges, and refrigerator enclosures.

**Never** open the pushbutton box on the motor. Should this be necessary, contact a qualified electrician. Make sure your fingers do not touch the plug's metal prongs when plugging or unplugging the log splitter.

- **KEEP VISITORS AND CHILDREN AWAY**

The log splitter must be always operated by one person only. Other people should keep a safe distance from the work area, especially when the log splitter is under operations. Never use another people to help you with freeing jammed log.

- **INSPECT YOUR LOG**

Make sure there are no nails or foreign objects in logs to be split. The ends of the logs must be cut square. Branches must be cut of flush with the trunk.

- **DON'T OVERREACH**

Floor must not be slippery. Keep proper footing and balance at all times.

**Never** stand on log splitter. Serious injury could occur if the tool is tipped or if the cutting tools is unintentionally contacted.

**Do not** store anything above or near the log splitter where anyone might stand on the tool to reach them.

- **AVOID INJURY FROM UNEXPECTED ACCIDENT**

Always pay full attention to the movement of the log pusher.

**Do not** attempt to load the log on until the log pusher has stopped.

Keep hands out of the way of all moving parts.

- **PROTECT YOUR HANDS**

Keep your hands away from splits and cracks which open in the log; They may close suddenly and crush or amputate your hands.

**Do not** remove jammed logs with your hands.

- **DON'T FORCE TOOL**

It will do a better and safer job at its design rate.  
Never try to split logs larger than those indicated in the specifications table.

This could be dangerous and may damage the machine.  
Don't use log splitter for a purpose for which it was not intended.

- **NEVER LEAVE TOOL RUNNING UNATTENDED**

Don't leave tool until it has come to a complete stop.

- **DISCONNECT POWER**

Unplug when not in use, before making adjustments, changing parts, cleaning, or working on the log splitter; Consult technical manual before servicing.

- **PROTECT THE ENVIRONMENT**

Take used oil to an authorized collection point or follow the stipulations in the country where the log splitter is used.

**Do not** discharge into drains, soil or water.

- **MAINTAIN YOUR LOG SPLITTER WITH CARE**

Keep the log splitter clean for best and safest performance.

- **MAKE THE WORKSHOP CHILDPROOF**

Lock the shop. Disconnect master switches.  
Store the log splitter away from children and others not qualified to use it.

3.0 Assembly instructions.

ASSEMBLY PARTS

Inspect all the parts when the product has been unpacked to ensure it is complete.



**Main Body**  
QTY: 1



**Rubber Stopper**  
QTY: 2



**Wheel Lock Clip**  
QTY: 2



**Wheel Cap**  
QTY: 2



**Wheel**  
QTY: 2



**Handle**  
QTY: 1

## Assembling the log splitter

Attach the rubber Stoppers (Part 2) at the support leg of the log splitter with supplied nut bolt.



Attach the handle (Part 6) to the front leg with supplied bolt)



Attach the wheels (part 5) to both wheel axles with wheel lock clips (part 3) . Clip the wheel cap(part 4) to the wheel( part 5) .



## Log splitter controller and parts

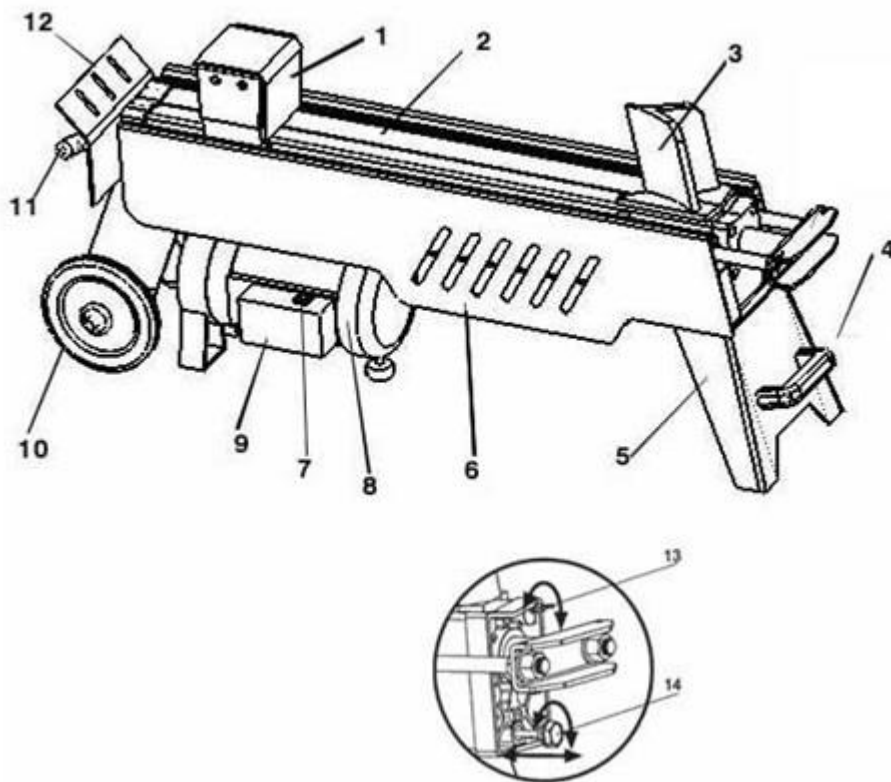

1. Log Pusher
2. Worktable
3. Wedge
4. Lift Handle
5. Support Leg
6. Log Retaining Plates
7. Switch
8. Motor
9. Pushbutton Box
10. Wheels for Minor Moving ONLY.
11. Hydraulic Control Lever
12. Control Lever Guard
13. Bleed Screw
14. Oil Drain Bolt w/ Dipstick



---

## 4.0 PRE-CHECKS BEFORE OPERATIONS

### WARNING!

**Before using the log splitter, ensure the Bleed Screw is loosened, by rotating it to allow air to escape the hydraulic system unhindered.**

**Airflow through the Bleed Screw hole should be detectable when the log splitter is in use.**

**Before storing or moving the log splitter, ensure the Bleed Screw is tightened to prevent oil leakages.**

**FAILURE TO LOOSEN THE BLEED SCREW WILL RETAIN SEALED AIR IN HYDRAULIC SYSTEM AND MAY DAMAGE THE PRODUCT VOIDING ITS WARRANTY**

---

### DO NOT ADJUST THE MAX PRESSURE LIMITING SCREW!

**Max pressure was set before the log splitter ex work and the max pressure limiting screw is sealed with glue to ensure the log splitter works under pressure no more than 8 tons.**

**The setting was done by qualified mechanic with professional instruments.**

**Unauthorized resetting will cause the hydraulic pump fail to output enough splitting pressure or **RESULT IN SERIOUS INJURY AS WELL AS DAMAGE TO THE MACHINE.****

---

### 4.1. Electrical requirements

Connect the main leads to a standard 230V+10% (50Hz+1Hz) electrical supply which has protection devices of under-voltage, over-voltage, over-current as well as a residual current device (RCD) which maximum residual current rated at 0.03A.

---

### 4.2. Select location

- Select an appropriate location for operating the log splitter.
- Dry-level surface with good footing. Stay clear of areas with mud, ice, tall grass, weeds, brush, or snow.
- If you start to feel sick, dizzy, or weak while using the log splitter, shut off the engine and get to fresh air **RIGHT AWAY**, See a doctor You may have carbon monoxide poisoning.
- Block the wheels to prevent unintended movement of the log splitter.
- Place a block behind the jockey wheel

## 5.0 Operations instructions

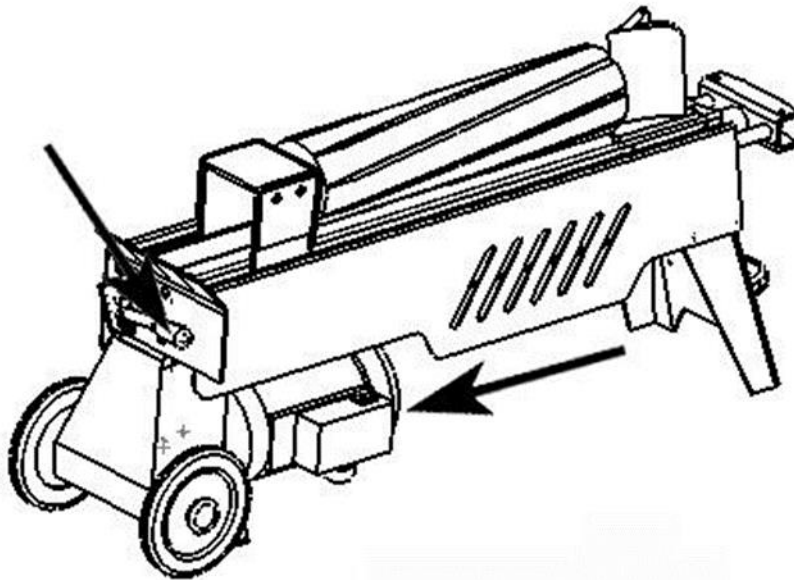

This log splitter is equipped with a “ZHB” control system that needs to be operated by both hands. Left-hand controls the hydraulic control lever while the user's right-hand controls the pushbutton switch.

The log splitter will freeze if either of the hands is absent from the controls. Only after both hands release the controls, the log pusher starts to return to the starting position.

Trigger type lock-out device is adopted to avoid accidental Hydraulic Control Lever pushdown. To operate the Hydraulic Control Lever, draw the Trigger backward with the index finger before pushing the Hydraulic Control Lever forward.

**CAUTION: DO NOT over-pressurize the log splitter by forcing it to split wood for longer than 5 seconds. Doing so will damage the product and void the warranty.**

For hardwood, try to split the wood by rotating it or by splitting from off-center. If you are not able to split the log, this means that its hardness exceeds the capacity of the machine and this log should be discarded

---

## 6.0 STORAGE, USAGE & MAINTENANCE

### 6.1. Loading Log

- Load the log onto beam with a straight cut end against the splitting wedge - positioned for a lengthwise cut
  - The log splitter is designed only for cutting lengthwise with the grain, **NOT** for cutting across the grain.
  - Hold bark side. Hold the bark side of logs when loading or positioning, never the ends.
  - Never place your hands or any part of your body between a log and any part of the log splitter.
- 

### 6.2. Operator Position

- ALWAYS operate the log splitter from the manufacturer's indicated OPERATOR POSITION
  - Other positions are unsafe because they can increase the risk of injury from crushing, cutting, flying objects, or burns.
- 

### 6.3. Second Person

- If loading a heavy log a 2nd person may be required to help load the log only Many accidents occur when there is more than one person involved in loading and operating the log splitter.
  - Only one person should operate the controls.
  - If a second person is assisting in loading logs, the operator must **NEVER** actuate the splitter Control Lever until the assistant and all bystanders are at least 10 feet away
  - **EVER** allow an assistant to hold the log in place while the operator actuates the Split Control Lever
  - **Hand activate**
    - Use only your hand to operate the Split Control Lever Never use any other body part, or a rope, cable, or other remote device to actuate the control.
- 

### 6.4. Log splitter operation

The log splitter will **not** move forward if either hand is not holding down the handle or green button. Only after both hands are released from the controls, the log pusher starts to return backward to the end on the machine

**Always set logs firmly on the log splitting wedge. Make sure logs will not twist, rock or slip while being split. Do not force the blade by splitting the log on the upper part. This will break the blade or damage the machine.**

Break log in the direction of its growing grain. **Do not** place log across the log splitter for splitting. It may be dangerous and may seriously damage the machine.

**Do not** attempt to split 2 pieces of logs at the same time. One of them may fly up and hit you.

---

## 6.5. Freeing a jammed log

- Release both controls.
- After the log pusher moves back and completely stops at its starting position, insert a wedge wood under the jammed log.
- Start the log splitter to push the wedge wood to go completely under the jammed one.
- Repeat above procedure with sharper slope wedge woods until the log is completely freed.

***Do not try to knock the jammed log off. Knocking about will damages the machine or may launch the log and cause accident.***

---

## 6.6. Replacing hydraulic oil

Replace the Hydraulic oil in the log splitter after every 150 hours of use. Take following steps to replace it.

- Make sure all moving parts stops and the log splitter is unplugged.
- Unscrew Oil Drain Bolt with Dipstick to remove it.
- Turn the log splitter on the Support Leg side over an 4 liters capacity container to drain the hydraulic oil off.
- Turn the log splitter on the motor side.
- Refill fresh hydraulic oil at the volume as per the hydraulic oil capacity of a particular model indicated in above specifications table.
- Clean the surface of Dipstick on the Oil Drain Bolt and put it back into the oil tank while keep the log splitter vertically.

- Make sure the level of the refilled oil is just between 2 grooves around the Dipstick.
- Clean the Oil Drain Bolt before thread them back. Make sure they are tightened to avoid leakage before place the log splitter horizontally.

***Periodically check oil level to ensure it is between 2 grooves around the Dipstick. Upon Lower oil level, oil refilling is required.***

Following hydraulic oils or equivalent are recommended for the log splitter's hydraulic transmission system:

- SHELL Tellus 22
- MOBIL DTE 11
- ARAL Vitam GF 22
- BP Energol HLP-HM 22

---

## 6.7. Sharpening the Wedge

After using the log splitters for some time, sharpen the wedge of the log splitter using a fine-toothed file and smooth any burrs or crushed area along the cutting edge.



### IMPORTANT

**If a part needs replacement only use genuine Yukon parts that meets the manufacturer's specifications.**

**Replacement parts that do not meet specifications may result in a safety hazard or poor operation of the log splitter.**

## 7.0 SPECIFICATIONS

### 7.1. Log Specification & Guide



**Square log ends.** Logs that are not cut square can slide out while splitting and become a safety hazard or cause excessive force to log splitter components. Use a chainsaw to cut logs square on each end before attempting to split them into single logs.



**Split along grain.** Do not use the log splitter to split logs across the grain. Doing so will damage the log splitter and could also cause pieces of log to be thrown, injuring the operator or bystanders.

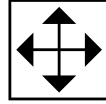

**Max Log Size.** The diameter of the log is indicative-a small log can be difficult to split when it has knots, tough fiber or green. On the other hand, it may not be difficult to split logs with regular fibers even if its diameter exceeds the Max Log size.

Max Splitting Length	Max Splitting Diameter
500mm	50-250mm



**Warning.** Splitting log that are not cut square or has knots or tough fiber or green or not along the grain will damage the log splitter which would not be covered under the manufacture warranty



### IMPORTANT

The manufacturer reserves the right to make improvements in design and/or changes in specifications at any time without incurring any obligation to install them on units previously sold

## 8.0 TROUBLESHOOTING

Problem	Probable Cause	Suggested Remedy
<b>Motor does not turn on</b>	Fuel not turn on	Make sure the power is turn on at the power point
	Is the log splitter straight into the power point or into a power board/power lead	Plug the log splitter direct into the power point
	Is the handle and safety switch held down together	Make sure you are holding down the safety switch and handle together
	Fault motor	The motor is faulty Please contact the Klika warranty department
<b>Fails to split logs</b>	Is the log with the size limit for the machine?	Please make sure the log is the with the size limit for the machine Max size is 5 ~ 25cm diameter and 52cm long.  Customer can refer to page ?? in the manual
	Log is improperly positioned	Make sure log is flat on the bed.  Please refer to page 8 in the manual
	Is the log being split along the grain	Make sure the log is being split along the natural grain in which the tree grow
	Try reposition the logs?	Reposition the log by turning it around or spinning it 90 deg
	Is the splitting wedge cutting edge is blunt?	If the splitting wedge is blunt it will need to be sharpen  Please see page ?? in the user manual
	Is the log fiber too hard for the capacity of the machine or is the wood knotty, wet or green?	This machine is not designed to split these type of logs. If the fiber of the wood is to hard wood knotty, wet or green you will need to wait to the wood is older to split
	Fault with the pump or hydrocoral system	There is fault with the pump or hydrocoral system Please contact the Klika warranty department

**The log pusher moves jerkily or vibrating a lot**

Have you check the oil levels	The log pusher moves jerkily or vibrating a lot
Is the item on flat solid surface?	Place item on flat level surface
Have the breath screw been undone?	Undo the breath screws
Fault with the ram or hydrocoral system	There is ram with the pump or hydrocoral system. Please contact the Klika warranty department

**Leaking oil**

Leaking oil Front of the machine	
Is the breather screw loose	Tighten up breather screw
Is there oil mark below the breather screw?	Seal on the breather nut is fault and will need to be replaced
Is the dip stick loose?	Tighten up dip stick
Is there oil mark below the dip stick?	Seal on the dip stick is faulty and will need to be replaced
Is the oil coming from the main seal in-between the ram and the casting?	There is a problem with the main seals in-between the ram and casing. Please contact the Klika warranty department
Is there a hole in the ram?	Please contact the Klika warranty department

Leaking oil Front of machine	
Is the oil coming from between the hydraulic pump and the motor	Tighten up the 6 bolts, if it is still leaking from there If still leaking oil O ring between hydraulic pump and the motor needs to be replaced
Is the oil coming from between the motor and the case iron housing	Tighten up the 3 bolts, if it is still leaking from there If still leaking oil the 2 O ring between the motor and the case iron housing needs to be replaced
Is there a hole in the ram?	Please contact the Klika warranty department

---

## 9.0 WARRANTY

- Kmate Pty Ltd provides a 12 month warranty for this product when used for domestic purposes. Commercial use of the product will void all warranty.
- The benefits of this warranty are provided in addition to other rights and remedies you may have under a law in relation to the goods and services to which this warranty relates. Our goods come with guarantees that cannot be excluded under the Australian Consumer Law. You are entitled to a replacement or refund for a major failure and for compensation for any other reasonably foreseeable loss or damage. You are also entitled to have goods repaired or replaced if the goods fail to be of acceptable quality and the failure does not amount to a major failure.
- Before making a claim under warranty, please refer to your user/installation manual to ensure that you have followed correct operating procedures of your product, and refer to the trouble shooting section (if such exists) to assist solving any problems.
- The warranty period begins from the day of purchase.
- Your proof of purchase must be produced before assistance will be provided.
- Where the Product is replaced pursuant to this Warranty, the replacement Product will be subject to the warranty terms and warranty commencement date of the original product.
- This warranty is only valid if the product is operated and maintained in accordance with the manufacturer's instructions.
- Damage to property including but not limited to grass, outdoor areas, outdoor furniture, walls, or any other event either directly or indirectly are excluded from warranty as well as any losses or expenses incurred by you in relation to the product or making a claim under this warranty including without limitation any costs associated with installation, reinstallation or transporting the product.
- A claim may be refused if the defective claim has arisen for reasons other than a manufacturers fault or defective parts or workmanship. Circumstances in which a warranty claim may be declined include, but are not limited to the following:
  1. Normal wear and tear
  2. Misuse or abuse, including failure to properly maintain or service
  3. Damages caused by improper or incorrect installation, force-majeure, abnormal outdoor conditions, inclement weather, lightning etc are not eligible for warranty repair
  4. Insect or vermin infestation; Failure to clean or improper cleaning and/or operation of the product
  5. If the product is modified without authorisation from Supplier in writing;

---

### Contact Details

*Kmate Pty Ltd*

*PO Box 234, Mount Waverley VIC 3149*

*Email: [warranty@klika.com.au](mailto:warranty@klika.com.au)*

*Phone: 03 9790 0055*

---



